

IRRIGATION NOTE:
 ALL LANDSCAPE AREAS, INCLUDING THOSE WITHIN THE R.O.W. SHALL BE IRRIGATED WITH AN AUTOMATIC UNDERGROUND IRRIGATION SYSTEM. THE SYSTEM SHALL OPERATE IN COMPLIANCE WITH LOCAL STANDARDS AND SEASONAL RESTRICTIONS. SEPARATE ZONES SHALL BE PROVIDED FOR LAWN AREAS AND PLANTING BEDS. IRRIGATION SHALL BE DESIGNED IN THE MOST EFFICIENT MANNER NECESSARY TO FULLY IRRIGATE ALL PLANTING AREAS.

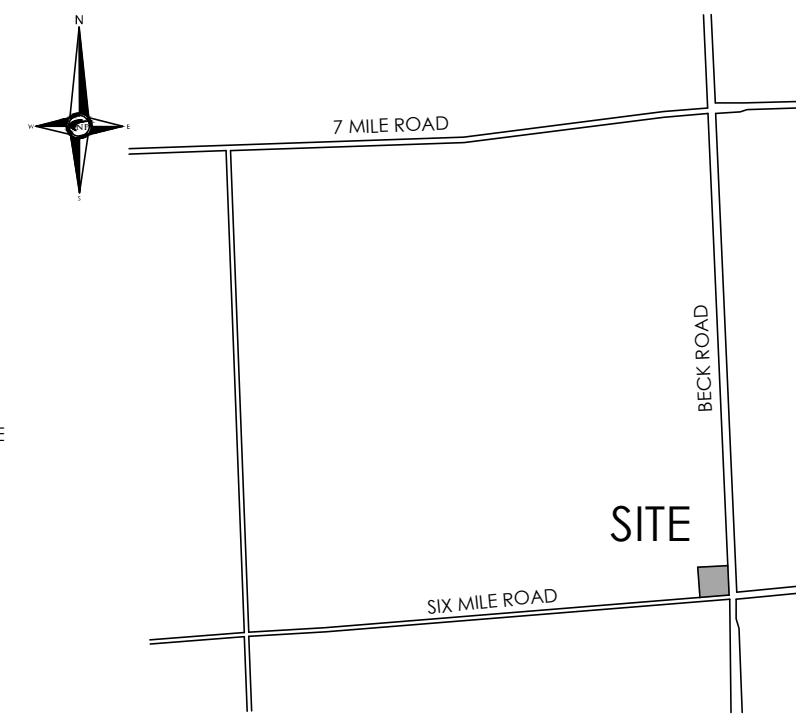

NOWAK & FRAUS ENGINEERS
 46777 WOODWARD AVE.
 PONTIAC, MI 48342-5032
 TEL. (248) 332-7931
 FAX. (248) 332-8257

LANDSCAPE REQUIREMENTS

- GREENBELT ABUTTING A R.O.W. (G)**
 1 TREE PER 3,000 S.F. OF PAVED AREA
 1 DECIDUOUS TREE AND 6 SHRUBS PER 40' LF. OF ROAD FRONTAGE REQUIRED.
 SIX MILE ROAD
 390.79 LF. / 40' LF. = 9.78 OR 10 TREES REQUIRED
 390.79 LF. / 40' X 4' = 58.46 OR 59 SHRUBS REQUIRED
 PROVIDED: 3 EXISTING TREES, 7 PROPOSED TREES, 60 SHRUBS
- BECK ROAD**
 362.51 LF. / 40' LF. = 9.06 OR 9 TREES REQUIRED
 362.51 LF. / 40' X 4' = 54.38 OR 55 SHRUBS REQUIRED
 PROVIDED: 9 PROPOSED TREES, 59 SHRUBS
- PARKING LOT LANDSCAPE REQUIREMENTS (P)**
 1 TREE PER 3,000 S.F. OF PAVED AREA
 38,190.26 S.F. / 3,000 S.F. = 12.73 OR 13 TREES
 PROVIDED: 13 TREES
- INTERIOR BUILDING/SITE LANDSCAPE (I)**
 1% OF SITE, EXCLUSIVE OF OTHER REQUIREMENTS
 1 TREE PER 400 S.F.
 1 SHRUB PER 250 S.F.
 8,766.53 S.F. X 1.0% = 1,314.98 S.F.
 REQUIRED:
 1,314.98 S.F. / 400 S.F. = 3.28 OR 4 TREES
 1,314.98 S.F. / 250 S.F. = 5.28 OR 6 SHRUBS
 PROVIDED: 4 TREES AND 20 SHRUBS
- STREET TREES (S)**
 REQUIRED:
 SIX MILE ROAD
 390.79 LF. / 40' LF. = 9.78 OR 10 TREES
 BECK ROAD
 362.51 LF. / 40' LF. = 9.06 OR 9 TREES
 PROVIDED:
 SIX MILE ROAD: 10 TREES
 BECK ROAD: 9 TREES
- RESIDENTIAL BUFFER ZONE (B)**
 TYPE D: 1 TREE AND 4 SHRUBS PER 20' LF. W/ 4.5' HT WALL OR BERM REQUIRED
N. PROPERTY LINE: 390.79 LF.
 390.79 LF. / 20' LF. = 19.54 OR 20 TREES
 390.79 LF. / 20' X 4' = 78.18 OR 79 SHRUBS
 PROVIDED: 20 TREES AND 80 SHRUBS. A WAIVER FOR WALL IS REQUESTED DUE TO GRADE DIFFERENTIAL
WEST PROPERTY LINE: 362.51 LF.
 362.51 LF. / 20' LF. = 18.13 OR 19 TREES
 362.51 LF. / 20' X 4' = 72.50 OR 73 SHRUBS
 PROVIDED: 19 TREES AND 74 SHRUBS, AND WALL
- WOODLAND REPLACEMENTS (W)**
 139 TREES REQUIRED
 35 TREES PROVIDED (104 TREES TO BE PAID INTO THE TREE FUND)

GENERAL LANDSCAPE NOTES

- LANDSCAPE CONTRACTOR SHALL VISIT SITE, INSPECT EXISTING CONDITIONS AND REVIEW PROPOSED PLANNING AND RELATED WORK. IN CASE OF DISCREPANCY BETWEEN PLAN AND FIELD SITE, THE PLAN SHALL GOVERN QUANTITIES. CONTRACT THE LANDSCAPE ARCHITECT WITH ANY CONCERNS.
- THE CONTRACTOR SHALL VERIFY LOCATIONS OF ALL ON-SITE UTILITIES PRIOR TO BEGINNING CONSTRUCTION. ON THE PHASE OF WORK, ANY DAMAGE OR INTERRUPTION OF SERVICES SHALL BE THE RESPONSIBILITY OF THE CONTRACTOR.
- THE CONTRACTOR SHALL COORDINATE ALL RELATED ACTIVITIES WITH OTHER TRADES, AND SHALL REPORT ANY DISCREPANCIES TO THE OWNER'S REPRESENTATIVE PRIOR TO COMMENCEMENT.
- PLANTS SHALL BE FULLY BRANCHED, AND IN HEALTHY VIGOROUS GROWING CONDITION.
- PLANTS SHALL BE WATERED BEFORE AND AFTER PLANTING IS COMPLETE.
- ALL TREES MUST BE STAKED, FERTILIZED AND MULCHED AND SHALL BE GUARANTEED TO EMIT A NORMAL GROWTH CYCLE FOR AT LEAST ONE (1) YEAR FOLLOWING PLANTING.
- ALL MATERIAL SHALL CONFORM TO THE GUIDELINES ESTABLISHED IN THE MOST RECENT EDITION OF THE AMERICAN STANDARDS FOR HURSEY STOCK.
- CONTRACTOR WILL SUPPLY FIBERED GRASS AND ENGRAVE AS NECESSARY TO SUPPLY PLANT AND DEPTH IN ALL PLANTING BEDS AS INDICATED IN PLANT DETAILS AND A DEPTH OF 4" IN ALL LAWN AREAS.
- PROVIDE CLEAN BACKFILL SOIL USING MATERIAL STOCKPILED ON-SITE. SOIL SHALL BE SCREENED AND FREE OF DEBRIS, FOREIGN MATERIAL, AND STONE.
- SLOW RELEASE FERTILIZER SHALL BE ADDED TO THE PLANT PIT BEFORE BEING BACKFILLED. APPLICATION SHALL BE AT THE MANUFACTURER'S RECOMMENDED RATES.
- AMENDED PLANT MIX (PREPARED TOPSOIL) SHALL CONSIST OF 1/3 SCREENED TOPSOIL, 1/3 SAND, AND 1/3 TONRY DOGY COMPOST. MIXED WELL AND SPREAD TO A DEPTH AS INDICATED IN PLANTING DETAILS.
- ALL PLANTINGS SHALL BE MULCHED WITH SHREDDED HARDWOOD BARK. SPREAD TO A DEPTH OF 3" FOR TREES AND SHRUBS, AND 2" FOR ANNUALS, PERENNIALS, AND GROUND COVER PLANTINGS. MULCH SHALL BE FREE FROM DEBRIS AND FOREIGN MATERIAL, AND PRICES TO BE APPROVED BY THE OWNER'S REPRESENTATIVE.
- NO SUBSTITUTIONS OR CHANGES OF LOCATION, OR PLANT TYPE SHALL BE MADE WITHOUT THE APPROVAL OF THE LANDSCAPE ARCHITECT.
- THE LANDSCAPE ARCHITECT SHALL BE NOTIFIED OF ANY DISCREPANCIES BETWEEN THE PLANS AND FIELD CONDITIONS.
- THE LANDSCAPE CONTRACTOR SHALL BE RESPONSIBLE FOR MAINTAINING ALL PLANT MATERIAL IN A VERTICAL POSITION THROUGHOUT THE GUARANTEED PERIOD.
- THE LANDSCAPE ARCHITECT OR OWNER'S REPRESENTATIVE SHALL HAVE THE RIGHT TO REJECT ANY WORK OR MATERIAL THAT DOES NOT MEET THE REQUIREMENTS OF THE PLANS AND/OR SPECIFICATIONS.
- THE LANDSCAPE CONTRACTOR SHALL SEE AND MULCH OR SOIL AS INDICATED ON PLANS. ALL AREAS DESIGNATED AS SUCH ON THE PLANS, THROUGHOUT THE CONTRACT PERIOD. FURTHER, THE CONTRACTOR SHALL BE RESPONSIBLE FOR RESTORING AREAS DISTURBED DURING CONSTRUCTION, NOT IN THE CONTRACT LIMITS, TO EQUAL OR BETTER CONDITION.
- ALL LANDSCAPE AREAS SHALL HAVE PROPER DRAINAGE THAT PREVENTS EXCESSIVE WATER FROM FLOODING ON LAWNS OR AROUND TREES AND SHRUBS.
- ALL LANDSCAPE AREAS SHALL BE IRRIGATED WITH AN AUTOMATIC UNDERGROUND SYSTEM.

GROUND COVER KEY

- TYPICAL SOD LAWN AREAS, SOWN ON 3" TOPSOIL
- HYDRO-SEED AND MULCH ON 3" TOPSOIL
- 4" DIA SPADE CUT EDGE W/ 3" SHREDDED BARK MULCH
- 3" DEPTH DOUBLE SHREDDED HARDWOOD BARK MULCH
- 3/16" X 4" METAL EDGING ON BEDS, STAKED PER MANUFACTURER

CAUTION!!
 6P-MP GAS MAIN

PLANT SCHEDULE

KEY	QTY	BOTANICAL/COMMON NAME	SIZE	SPACING	ROOT	COMMENT
TREES						
AA	14	Acer rubrum 'Armstrong'	2.5' CAL	SEE PLAN	B&B	FULLY BRANCHED HEADS
AR	6	Acer rubrum 'Bowhall'	2.5' CAL	SEE PLAN	B&B	FULLY BRANCHED HEADS
BN	12	Betula nigra 'River Birch'	12-14' HT	SEE PLAN	B&B	CLUMP FORM, 3 CANES
CC	10	Carpinus caroliniana 'American Hornbeam'	2.5' CAL	SEE PLAN	B&B	FULLY BRANCHED HEADS
CR	9	Cercis canadensis 'Eastern Redbud'	2.5' CAL	SEE PLAN	B&B	FULLY BRANCHED HEADS
GT	10	Quercus bicolor 'Northern Acclaim'	2.5' CAL	SEE PLAN	B&B	FULLY BRANCHED HEADS
LT	15	Lilium 'Tulip Tree'	2.5' CAL	SEE PLAN	B&B	FULLY BRANCHED HEADS
PG	16	Picea canadensis 'Densaata'	8' HT	SEE PLAN	B&B	FULL TO GROUND
PO	19	Picea canadensis 'Spartan Spruce'	8' HT	SEE PLAN	B&B	FULL TO GROUND
PC	4	Pinus caryinata 'Redspire'	2.5' CAL	SEE PLAN	B&B	FULLY BRANCHED HEADS
TA	11	Tilia americana 'McSentry'	2.5' CAL	SEE PLAN	B&B	FULLY BRANCHED HEADS
SHRUBS						
AM	22	Aronia melanocarpa 'Black Chokeberry'	30' HT	4' OC	B&B	
CS	31	Cornus sericea 'Boyley'	36' HT	5' OC	B&B	
FX	42	Forsythia x 'Lynwood Gold'	36' HT	4' OC	B&B	
IG	112	Ilex glabra 'Shogbox'	30' HT	30' OC	B&B	MAINTAIN AS HEDGE
JV	22	Juniperus virginiana 'Red Cedar'	6' HT	8' OC	B&B	
RK	20	Rosa 'Double Knockout'	30' HT	30' OC	B&B	
TO	6	Thuja occidentalis 'Smaragd'	5' HT	3' OC	B&B	SHEAR AT UNIFORM 5' HT
VC	37	Viburnum coccineum 'Korean Spice'	36' HT	6' OC	B&B	
GROUND COVERS/PERENNIALS						
CA	92	Carex acutata 'Karl Foerster'	3 GAL	30' OC	CONT	
HS	8	Hemerocallis 'Purple D'Oro'	2 GAL	24' OC	CONT	
LR	84	Liriodendron 'Creeping Liriodendron'	1 GAL	15' OC	CONT	TRIANGULAR SPACING

WAYNE COUNTY NOTES

- ALL WORK WITHIN THE WAYNE COUNTY ROAD RIGHT-OF-WAY SHALL BE IN ACCORDANCE WITH THE CURRENT STANDARDS AND GENERAL SPECIFICATIONS, INCLUDING SOIL EROSION AND SEDIMENTATION CONTROL OF WAYNE COUNTY DEPARTMENT OF PUBLIC SERVICES.
- THESE PLANS ARE NOT VALID WITHOUT ATTACHMENT OF THE WAYNE COUNTY PERMIT SPECIFICATIONS FOR CONSTRUCTION WITHIN ROAD RIGHTS-OF-WAY, PARKS, DRAINAGE ESTABLISHMENTS OR SANITARY SEWER UNDER THE JURISDICTION OF WAYNE COUNTY (03/01/03), REVISED 12/15/04.
- ALL DISTURBED AREAS WITHIN THE COUNTY RIGHT-OF-WAY OUTSIDE OF THE PAVEMENT AREA SHALL BE RESTORED WITH 3" TOPSOIL, SEED MIX AND MULCH OR WITH ENCLOSED CONTROL BLANKETS, SLOPES STEEPER THAN 1:3 SHALL BE RESTORED BY PLACING SOD.

CAUTION!!
 6P-MP GAS MAIN

SEAL

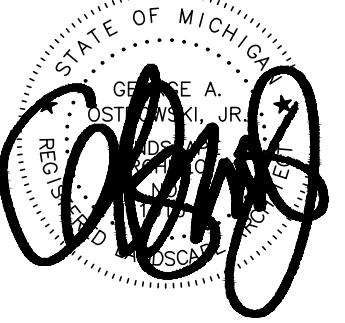

PROJECT
 47500 6 Mile Road
 6 Mile Rd. and Beck Rd.
 Northville Township

CLIENT
 JS Capital Group
 155 Romeo Road
 Rochester, Michigan 48307

Contact: Jeff Schmitz
 Phone: (248) 650-9850

PROJECT LOCATION

Part of the SE 1/4 of Section 8
 T.1S., R.8E.
 Northville Township,
 Wayne County, Michigan

SHEET

Landscape Plan



REVISIONS

NO.	DATE	DESCRIPTION

DRAWN BY:
 G. Ostrowski

DESIGNED BY:
 G. Ostrowski

APPROVED BY:
 G. Ostrowski

DATE:
 12-08-21

SCALE: 1" = 30'

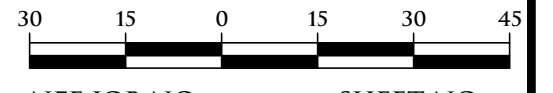

NFE JOB NO. M637 **SHEET NO. L2**

